

Isowarm – Tackerboard System

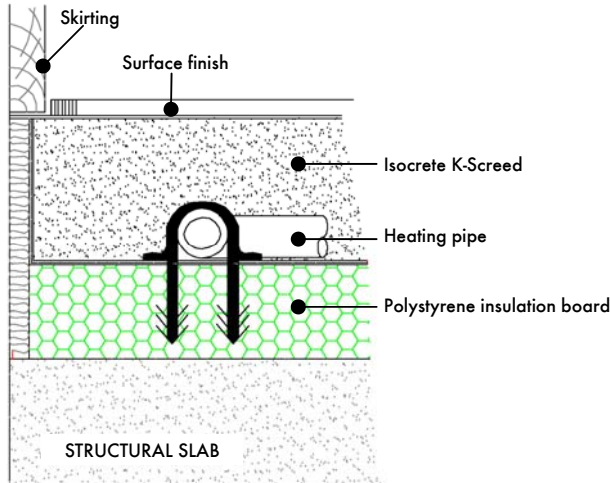

Description

Isowarm is a complete underfloor heating system incorporating insulation, pipework and associated retaining system and screed.

Uses

Efficient heating of many types of building including most commercial and residential applications e.g. schools, hospitals, prisons, airports, shopping centres, offices, hotels, theatres, flats and houses. The system can also incorporate acoustic insulation.

Benefits

- Unique design, simple and quick to install
- Unique pipe retention system – pipes do not slip or float in screed and can be trafficked before screed laying with minimal risk of damage to pipes or insulation
- Unique membrane, built into insulation, cannot leak
- No joints in pipes
- Energy cost savings of up to 24% against conventional radiator based systems (BSRIA studies)
- Maintenance free for the lifetime of the building
- Uniform temperature within zone
- Complete flexibility of room layout (no radiators to accommodate)
- Complete installation by one contractor to include all system elements, insulation, membrane, edge isolation, joints, pipework, manifolds, cabinets, actuators, room thermostats and screeds
- Can include acoustic separation resilient layer as optional extra
- Overall system thickness can be as little as 75 mm
- Flexibility of zone temperature control, from whole building to individual rooms
- Product and design guarantee for complete system
- High speed installation

ISOWARM TACKERBOARD SYSTEM

NB (1) Polyurethane insulation boards available to order.
NB (2) EPS boards of other thickness available to order.

System Design

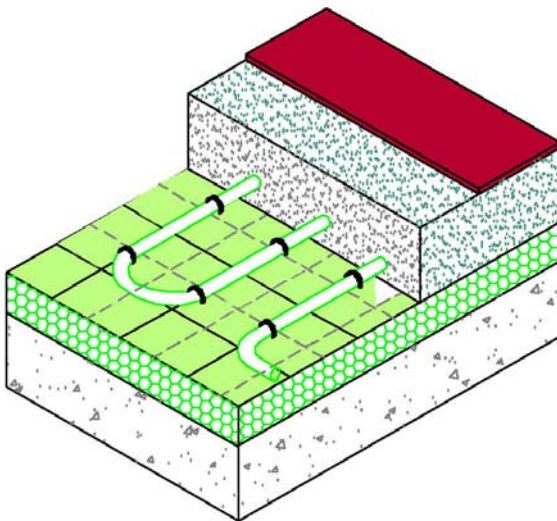

Project References

Stonehouse Hospital (Health);
New College, Durham (Education);
Bushberry Triangle (Education);
Cave Home, Derby (Health);
Large House, Prestwick (Domestic)

Surface Heat Output = Watts/m²

Guidance Only

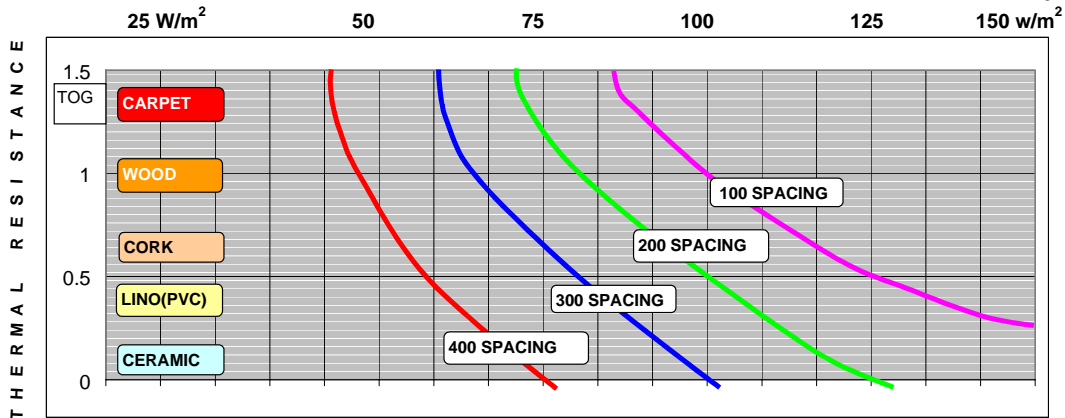

Model Specifications

Product: Isowarm

Preparatory work and application in accordance with manufacturer's instructions.

Manufacturer: Flowcrete UK Ltd

Isowarm Tackerboard:-

Typically 50 mm EPS 100 laminated insulating board (25 mm to upper floors, Isowarm 16 mm diameter cross linked polyethylene (PEX) pipework, minimum 50mm anhydrite screed or 65 mm Isocrete K-Screed and all associated Isowarm manifolds, cabinets, thermostats, edge separation and joints, all in accordance with the design produced by Isowarm.

Installation Service

The installation should be carried out by an Isowarm licensee with a documented quality assurance scheme. Obtain details of our licensed contractors by contacting our customer service team or enquiring on our website www.flowcrete.com

Environmental considerations

The complete system is assessed as non-hazardous to health and the environment. All products have been chosen to permit future recycling or reuse at the end of useful life. The absence of radiators or bulky heat emitters provides a more aesthetically acceptable environment with minimal impact.

Focus on the Floorzone

Flowcrete Group plc are world leaders in specialist industrial and commercial flooring. Systems available include: underfloor heating systems, floor screeds, surface damp proof membranes, decorative floor finishes, seamless terrazzo, car park deck waterproofing, corrosion resistant systems... to name just a few. Our objective is to satisfy your Floorzone needs.

Important Note

Flowcrete's products are guaranteed against defective materials and manufacture and are sold subject to its standard Terms and Conditions of Sale, copies of which can be obtained on request.

Typical Details

Thickness insulation	GF	EPS 100	50 mm
	UF	EPS 100	25 mm

Screed type	Minimum covering over pipes	Screed thickness overall
Anhydrite	30 mm	50 mm (min)
Isocrete K-Screed	40 mm	65 - 75 mm

Pipe diameter (OD)	16 mm
Acoustic insulation	Optional
Water temp flow (± 5 °C)	35 to 50 °C
Water temp return (± 5 °C)	25 to 40 °C
Typical maximum surface working temp	29 °C
Normal max heat output (at 20 °C)	100 W/m ²

Avoid abrupt changes in thickness which can lead to formation of screed cracks.

Further Information

To ensure you are specifying a fit for purpose flooring system for your project please consult our Technical Advisors on the number below or visit our website to register your interest in specifying one of the most durable floors on the market.

Flowcrete UK Ltd.
Booth Lane, Maston, Sandbach,
Cheshire, CW11 3QF. UK
Tel: +44 (0)1270 753000
Fax: +44 (0)1270 753333
Email: uk@flowcrete.com

Flowcrete Sweden AB
SE-284 80 Perstorp
Sweden
Tel: +46 435 386 30
Fax: +46 435 314 98
Email: sweden@flowcrete.com

Flowcrete International Ltd.
Lot 37631 & 37632, Jalan 6/37A,
Taman Bukit Maluri,
Industrial Area Kepong,
52100 Kuala Lumpur, Malaysia.
Tel: +60 3 6277 9575
Fax: +60 3 6277 4645
Email: malaysia@flowcrete.com

Flowcrete North America, Inc.
11133 I-45 South
Suite J, Conroe
Texas 77302
U.S.A.
Tel: +1 936 539 6700
Fax: +1 936 539 6701
Email: usa@flowcrete.com

Flowcrete
for the world at your feet